

The TUBE Spotlight is a classic stirrup & tube assembly to providing flexible lighting control with via its balanced geometry. With a wide range of lumen outputs, beam angles, lamp colours, accessories and finishes this luminaire is a must for high intensity, high quality and high efficiency spotlighting or area floodlighting. Also available in pendant, surface & floor standing versions.

Applications:

- Retail
- Exhibition
- Architectural
- Hospitality
- Residential
- Entertainment

Options: See mounting options on page 2

- Track mounting
- Disc-mount Screw Fix
- Surface Mount Cup
- Hook clamp

Accessories: See accessories on page 2

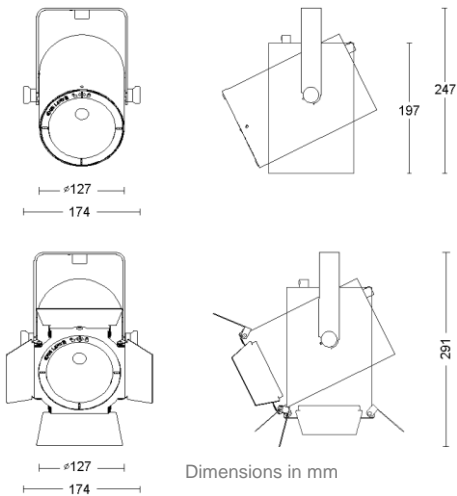

Part number examples

Part Number	Description
TUBSMB8V1800N830W	TUBE:SPOT:INT-SURF-MNT: B8V:1800LM NAR-BEAM:3K80CRI:WHITE
TUBT3B8V3800M930B	TUBE:SPOT:INT-TRK3CKT: B8V:3800LM MED-BEAM:3K90CRI: BLACK

Nomenclature:

TUB = Eclipse Family
SI = Spotlight with integral driver in housing
T3 = Track mounted 3CKT Global
T3E = Track mounted 3CKT Eutrac
SMB = Surface mounted cup Ø80mm
B8V = Bridgelux Vero18 LED
1800 = Exit Lumens*(averaged across colours)
2500 = Exit Lumens*(averaged across colours)
3800 = Exit Lumens*(averaged across colours)
4200 = Exit Lumens*(averaged across colours)
N = Narrow beam 10 - 20 degrees
M = Medium beam 20 - 30 degrees
W = Wide beam 30 - 50 degrees
XW = Extra Wide beam >50 degrees
HC = Honeycomb
EL = Elongation Lens
FB = Filter Lens: Bakery***
FM = Filter Lens: Meat***
FF = Filter Lens: Fish***
927 = 90CRI 2700K***
830 = 80CRI 3000K***
930 = 90CRI 3000K***
840 = 80CRI 4000K***
W = RAL9010 Pure White**
G = RAL9006 Grey Silver**
B = RAL9005 Jet Black**
BDB = Barn door black

* Refer to lumen output table for exact lumen output (all lumens are exit lumens).
** Other finishes available to special order.
*** Other colour options are available on request: please contact our sales team to discuss your requirements.

The Accessory range enables you to adapt the standard product, and optimise the perfect effect for your application. All accessories can be pre-assembled to each individual product, or ordered as a separate item so to customise an existing installation. Please specify clearly when ordering.

Accessories:

- Honeycomb
- Elongation lens
- Colour filter options

Honeycomb: For reduced glare.

Elongation Lens: For spreading the beam in one direction.

Filter Lens: For enhancing the display.

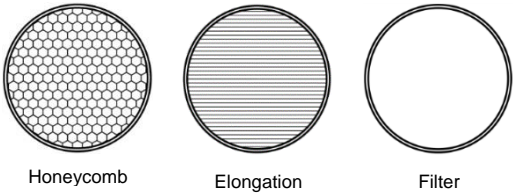

Reflector and Other Accessory Part numbers:

Part No.	Description
5080-15	REFLECTOR:GIRO-COB:108:15 DEGREE:1090AL
5080-28	REFLECTOR:GIRO-COB:108:28 DEGREE:1090AL
5080-40	REFLECTOR:GIRO-COB:108:40 DEGREE:1090AL
5080-60	REFLECTOR:GIRO-COB:108:60 DEGREE:1090AL
1295W	RING:SPARKLE:GIRO:1295:WHITE

Part number examples: Accessories purchased separately

Part Number	Description
AC125HC	ACCESSORY:125MM:HONEYCOMB
AC125EL	ACCESSORY:125MM:ELONGATION LENS

Optical Accessory options:

AC = Accessory

125 = For 75mm Optics

HC = Honeycomb

EL = Elongation Lens

FB = Filter Lens: Bakery

FM = Filter Lens: Meat

FF = Filter Lens: Fish

All above items are supplied pre-assembled within a Black plastic carrier as standard.

Other colour filter options are available on request: please contact our sale team to discuss your requirements.

Lumen output:

CRI CCT	Luminaire output Lumens and (Efficiency in Luminaire Lumen Per Watts) at typical drive current (mA) and forward voltage (V) DC							
	500mA 27V		700mA 28V		1050mA 29V		1185mA 29V	
	LED watts	Total watts	LED watts	Total watts	LED watts	Total watts	LED watts	Total watts
	13.7	15.7	19.5	22.5	30.5	33.5	34.5	39.0
927	1722 (110)		2377 (106)		3340 (100)		3625 (93)	
830	2158 (137)		2979 (132)		4186 (125)		4542 (116)	
835	2214 (141)		3056 (136)		4294 (128)		4659 (119)	
930	1785 (112)		2465 (110)		3463 (103)		3758 (96)	
840	2235 (142)		3086 (137)		4336 (129)		4705 (121)	
	¹ 1800 Typical		² 2500 Typical		³ 3800 Typical		⁴ 4200 Typical	

